

WINEGARD®

Carryout™

Portable Digital Satellite Antenna Model PM-2000

Assembly and Operating Instructions

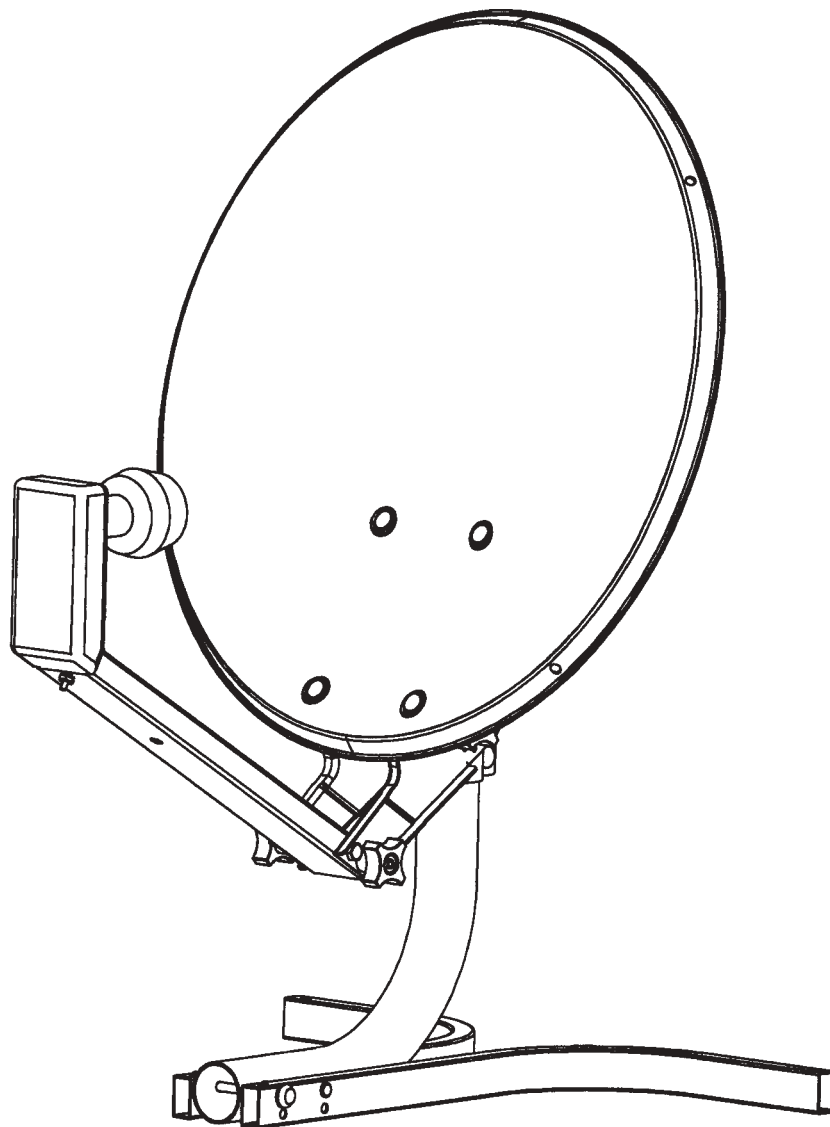

ASSEMBLY

MOUNT ASSEMBLY

STEP 1. Position legs and mount pipe as shown in Figure 1.

FIGURE 1

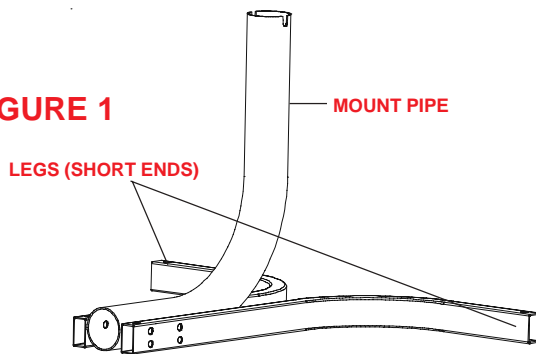

STEP 2. Attach mount pipe and legs using (2) 1/4" flat washers, (2) 1/4" nylon washers, (1) 1/4" nylock nut, and (1) 3-1/2" hex head cap screw. Insert the screw through the top left hole of leg as shown in Figure 2. Insert washers and install nylock nut. Tighten using (2) 7/16" wrenches.

FIGURE 2

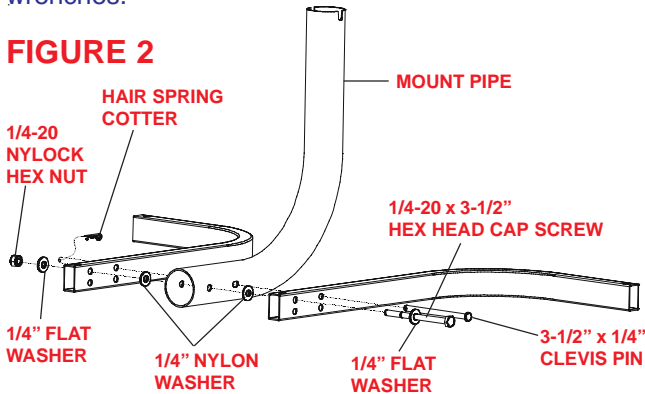

STEP 3. Insert 3-1/2" clevis pin into the top-right hole of the leg as shown in Figure 2. Secure with hair spring cotter.

MOUNT PIPE/DISH BRACKET ASSEMBLY

STEP 4. Line up long bolt inside dish bracket assembly (Figure 4) with the slots on top of the mount pipe.

STEP 5. Secure dish bracket assembly to mount pipe with (2) 1/4-20 x 1" carriage bolts, (2) 1/4" flat washers, and (2) 1/4-20 flanged hex nuts. See Figure 3.

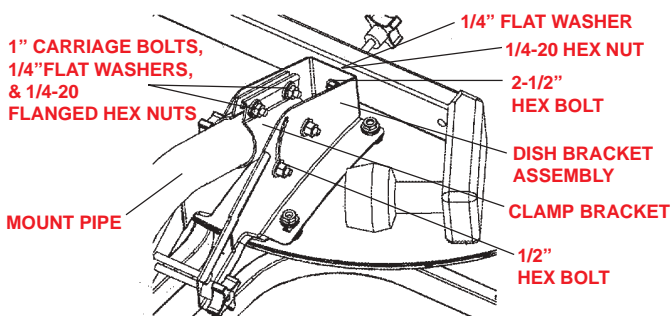

FIGURE 3

STEP 6. Insert 2-1/2" hex bolt from inside dish bracket out through hole on top of dish bracket assembly. Secure with (1) 1/4" flat washer, (1) 1/4-20 hex nut, and 1/4-20 locking knob. **NOTE: The locking knob is used to secure the feed tube when in the storage position.**

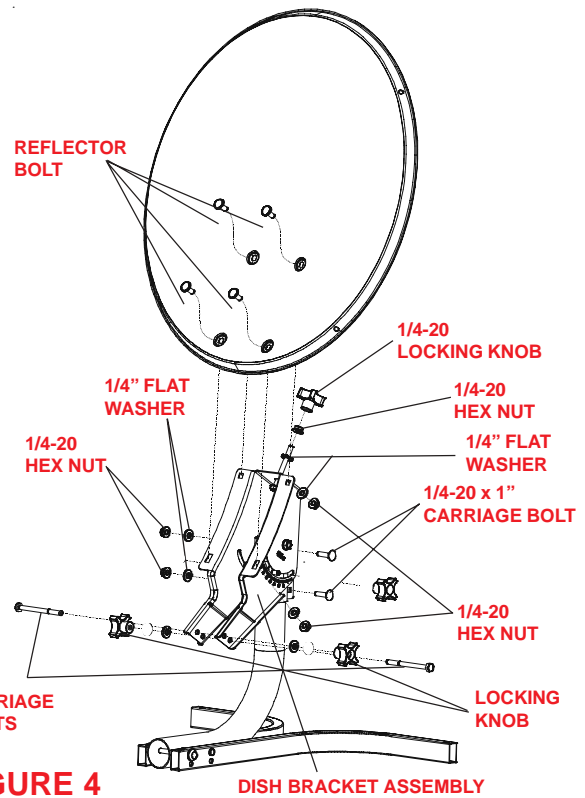

FIGURE 4

STEP 7. Install (1) 1/2" carriage bolt into inside hole of clamp bracket (side opposite of numbers on dish bracket assembly) and secure with 1/4" Nylock nut.

Install (1) 1/2" carriage bolt into inside hole of clamp bracket (side with numbers on dish bracket assembly) and insert elevation indicator washer over 1/2" bolt and secure with 1/4-20 locking knob.

NOTE: Stud should be facing outward. For both 1/2" bolts.

DISH ASSEMBLY

STEP 8. Attach reflector using (4) reflector bolts, (4) 1/4" flat washers, (4) 1/4-20 hex nuts. See Figure 4.

LNBF/FEED TUBE ASSEMBLY

(See Figure 5 for steps 9-13)

STEP 9. Feed 5' coax through feed tube and attach to LNBF.

STEP 10. Make sure the square hole is facing up on the feed tube, then attach LNBF to the feed tube using (1) 8-32 x 1-1/4" carriage bolt and using (1) 8-32 hex nut. Tighten enough so that the LNBF is secure.

STEP 11. Insert (2) 1/4-20 x 2.5" carriage bolts (opposite directions) into the bottom two holes of the dish bracket assembly. Insert a washer and a locking knob onto each threaded bolt. **DO NOT tighten at this time.**

STEP 12. Slide feed tube onto carriage bolts and tighten locking knobs.

STEP 13. Attach splicing connector to 5' cable and then attach 20' coaxial cable to splicer. 20' coaxial cable attaches to "SATELLITE IN" on receiver.

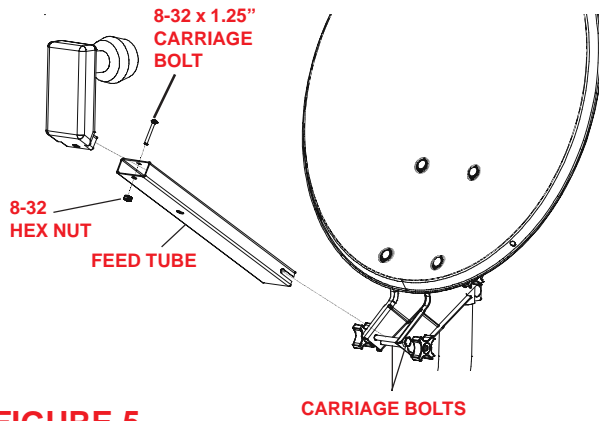

FIGURE 5

INSTRUCTIONS FOR STORAGE

STEP 1. Disconnect 20' coaxial cable from receiver.

STEP 2. Remove LNBF/feed tube assembly from dish bracket assembly.

STEP 3. Store LNBF/feed tube assembly on top of dish bracket assembly, with LNBF facing downward. Tighten locking knob. See Figure 6.

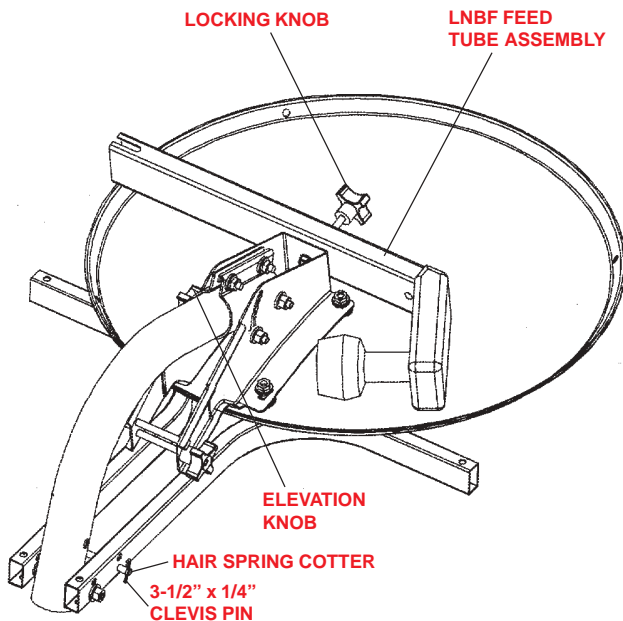

FIGURE 6

STEP 4. Remove clevis pin and hair spring cotter from legs and loosen elevation locking knob.

STEP 5. Swing legs underneath reflector and tip forward. Insert clevis pin back into original hole and secure with hair spring cotter. Tighten elevation locking knob.

If you require a replacement part, call Winegard Company at 1-800-288-8094 between the hours of 8:00 a.m. and 4:00 p.m. -central time, Monday through Friday. Credit card holders only. If you need technical support, call 1-800-788-4417.

INSTRUCTIONS FOR RECEIVING A SIGNAL

STEP 1. After assembling the antenna, make sure it is resting on a flat level surface.

STEP 2. Determine the azimuth (direction) and elevation angle (up/down) by entering your zip code into the appropriate set-up menu on your receiver.

STEP 3. To set the elevation angle (up/down), loosen the knob on the "elevation indicator washer" and elevate the "dish bracket" to the correct angle shown on the menu screen.

STEP 4. Using a compass, rotate the base slowly until the center of the dish faces the desired azimuth angle (direction) shown on the menu screen. **The signal is digital; you must wait a few seconds after each move to allow the receiver to process the signal.**

STEP 5. Adjust azimuth (direction) and elevation (up/down) for strongest signal.

MOBILE PRODUCTS & LNBF TWO YEAR LIMITED WARRANTY

Winegard Company warrants this Winegard product against any defects in materials or workmanship within two (2) years from date of purchase. No warranty claim will be honored unless at the time the claim is made, you present proof of purchase to an authorized Winegard dealer (if unknown, please contact Winegard Company, 3000 Kirkwood Street, Burlington, IA 52601-2000, Telephone 319-754-0600).

Winegard Company (at its option) will either repair or replace the defective product at no charge to you. This warranty covers parts, but does not cover any costs incurred in removal, shipping or installation of the product. This limited warranty does not apply if the product is damaged, deteriorates, malfunctions or fails from: misuse, improper installation, abuse, neglect, accident, tampering, modification of the product as originally manufactured by Winegard, usage not in accordance with product instructions or acts of nature such as damage caused by wind, lightning, ice or corrosive environments such as salt spray and acid rain.

The Two (2) Year Warranty is provided on the condition that the equipment is properly delivered with all handling and freight charges prepaid to your Winegard dealer for return to our factory for repair or replacement. Winegard dealers will arrange for the replacement or repair and return to you without charge the product which failed due to defective material or workmanship.

WINEGARD COMPANY WILL NOT ASSUME ANY LIABILITIES FOR ANY OTHER WARRANTIES, EXPRESS OR IMPLIED, MADE BY ANY OTHER PERSON.

ALL OTHER WARRANTIES WHETHER EXPRESS, IMPLIED OR STATUTORY INCLUDING WARRANTIES OF ABILITY ARE LIMITED TO THE TWO YEAR PERIOD OF THIS WARRANTY.

The foregoing shall be the sole and exclusive remedy of any person, whether in contract, tort or otherwise, and Winegard shall not be liable for incidental or consequential damage or commercial loss, or from any other loss or damage except as set forth above.

Some states do not allow limitations on how long an implied warranty last, or the exclusion of limitation of incidental or consequential damages, so the above limitations or exclusions may not apply to you.

This warranty gives you specific legal rights and you may also have other rights which vary from state to state.

FIGURE 7

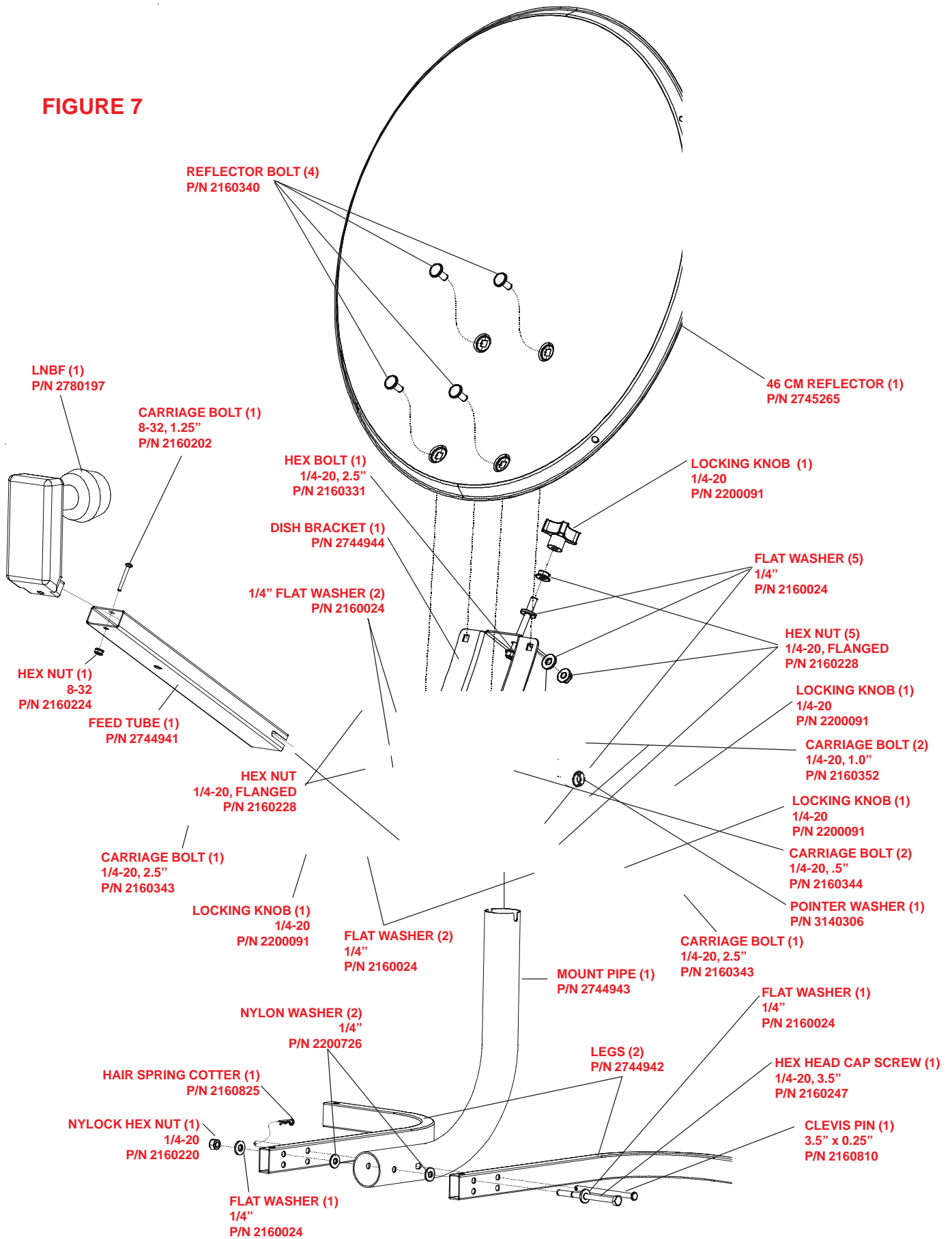

WINEGARD®